



Jetlag Travel Alarm Clock



Jetlag has two digital displays – a larger one for time, and a smaller one for alarm – that are always visible. Changing the time becomes simpler than ever before, with adjustment buttons clearly dedicated to each display. The reverse of the clock has a lock button for traveling. Other functions include a light button and an alarm/snooze button. The display is illuminated when the alarm is activated. Every detail from the interface to the size (half a passport) and material has been carefully considered to result in a clarity rarely seen in this type of product.

Size 90 x 62 x 21mm
ABS plastic, natural finish
Polycarbonate Lens

Available in Red, Black, Light Grey
Manufactured by IDEA International, Japan
'Best Travel Product 2008' by ID Magazine

This product is made from recyclable plastic.
No surface paint has been used that could interfere with its recycling performance.

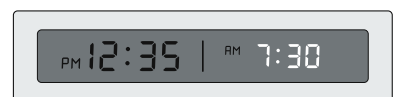
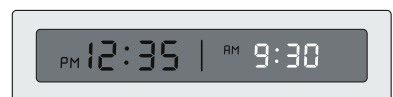
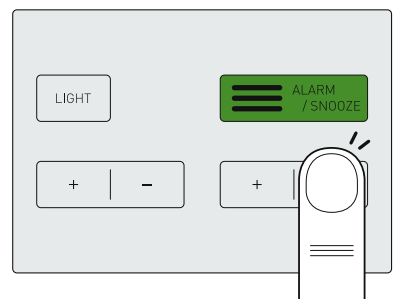

To Adjust the alarm, press the plus or minus button directly above the alarm display. You can also adjust for local time by pressing the plus minus button above the time display. To activate the alarm, press the alarm/snooze button.